

The Church of Our Saviour

Practicing God's Graciousness



WELCOME!



Mid-Year Parish Meeting
August 30, 2009

Opening Prayer

Everliving God, whose will it is that all should come to you through your Son Jesus Christ: Inspire our witness to him, that all may know the power of his forgiveness and the hope of his resurrection; who lives and reigns with you and the Holy Spirit, one God, now and for ever. Amen.

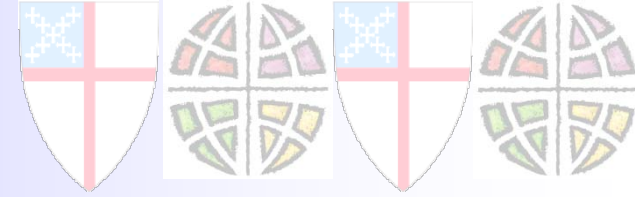

Agenda

- **Treasurer's report**
- **The Dream Team**
- **Columbarium report**
- **Ministry Team reports**
 - > **Welcoming**
 - > **Outreach**
 - > **Altar Guild**
 - > **Worship**
 - > **Christian Formation**
 - > **Pastoral Care**
- **Your Vestry: setting goals and moving forward!**

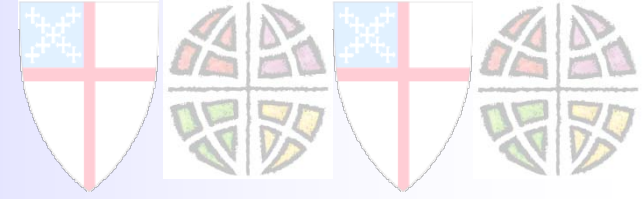

Treasurer's Report



2009 Income / Expenses Summary Year To Date (Jan-Jul)

Category	Income	Expenses / Fund Pay Out
Beginning Balance 1/1/09	\$22,219	
2009 Operating	\$70,525*	\$90,833
2009 Designated	\$4,110*	\$515 (To columbarium paid out against designated acct.)
2009 Pass Through	\$4,277*	\$2,627 (paid out)
2009 YTD Totals (Jan-Jul) * Totals from fund report + beginning balance	\$101,131	\$93,975 (from income/expense statement)
Ending Balance	\$7156	
Need to Fund	(\$5,245)	
Final Balance 7/31/09	\$1,911	

2009 Actual Income Distribution (Jan-July)

2009 Actual YTD Income: \$78,913

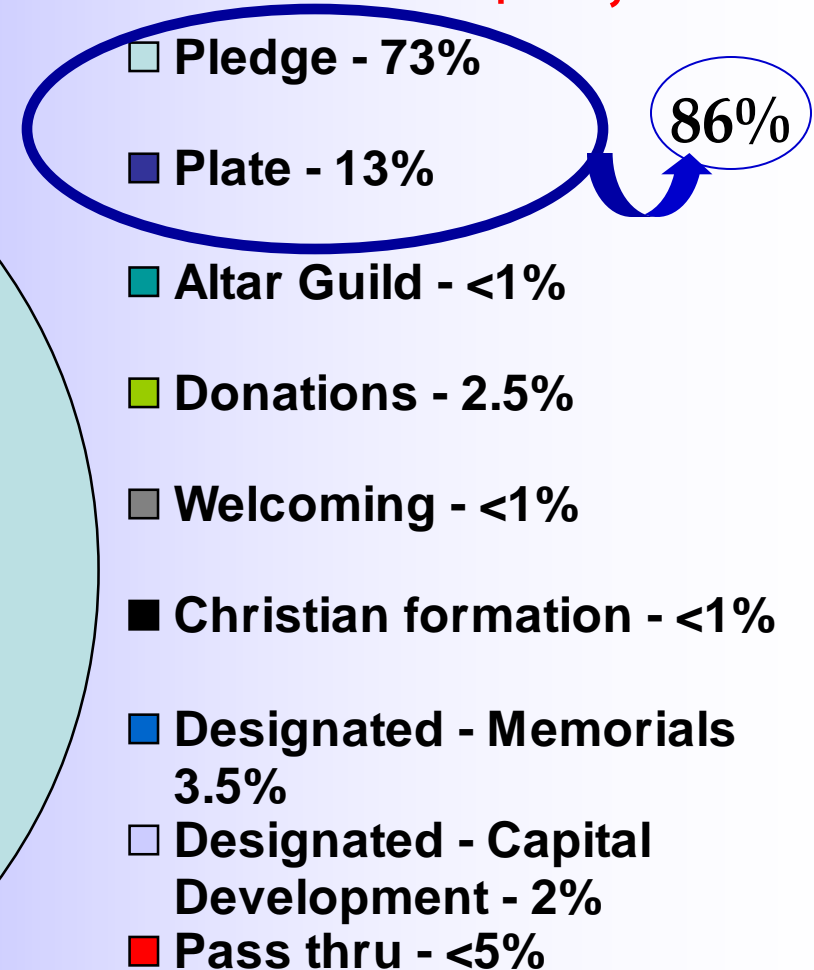
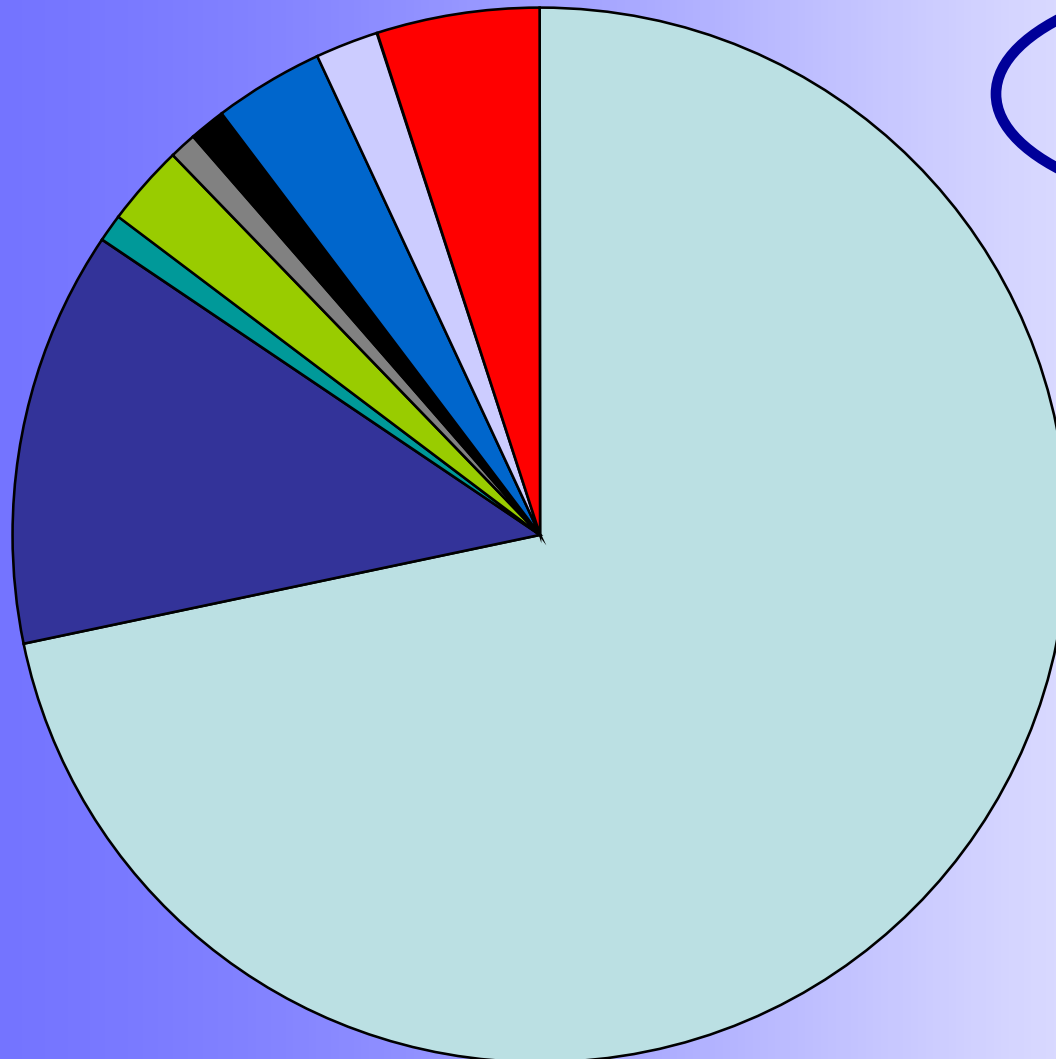

2009 YTD (Jan-Jul) Actual Expenses Designated & Pass through Funded

2009 Actual YTD Expenses: \$93,975

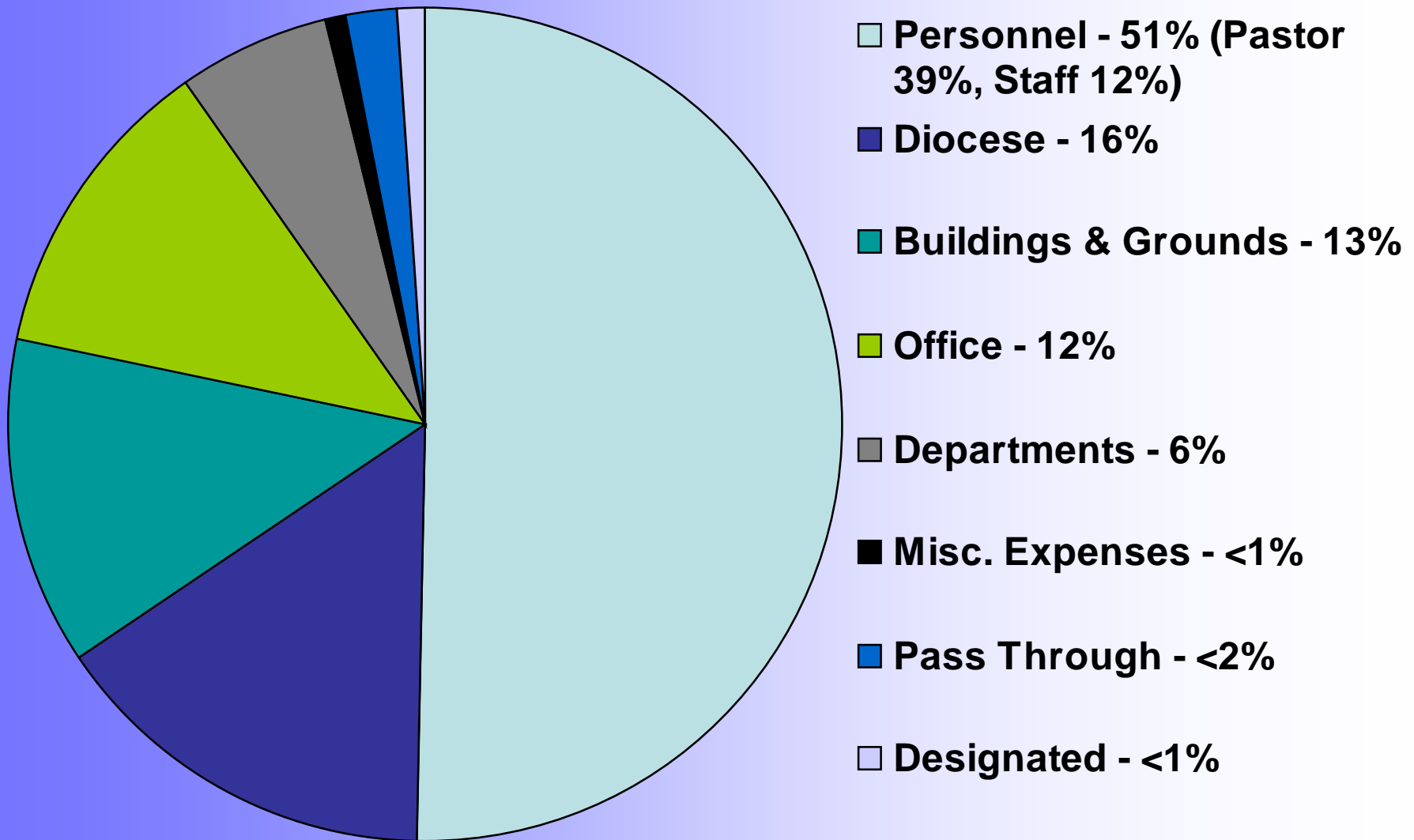

A few words from our
Senior Warden, Jerry Howell.

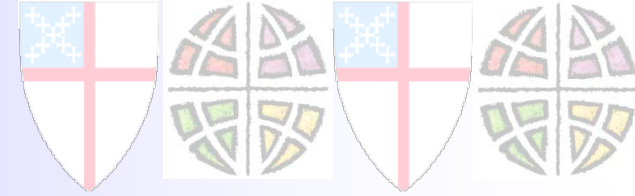

The Horizon Commission or Dream Team

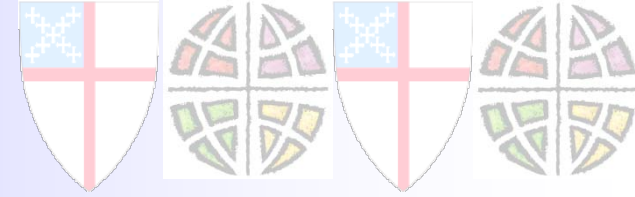

History of the Commission

Formed in 2005 to examine possible future needs.

**There have been several changes during the last 4 years.
However the:**

- Basic role is to look forward 10 to 20 years;**
- To recommend actions to meet projected needs;**
- To establish a strategic plan; and**
- To continue to modify plan as needs demand.**

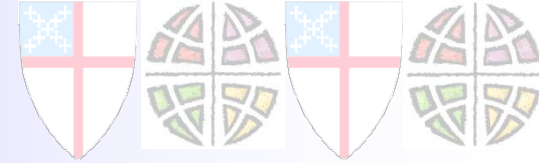

Review of Initial Work of 2005

- **Impact of demographic study for this area**
- **Expect doubling of parish in 15-20 years.**
- **Could be higher if the percentage of population increases**
- **Identified need is for a sanctuary and parish hall to seat at least 200 people**
- **The current campus is already too small for some functions (at 4,500 sq. ft)**
- **Existing site will not accommodate anticipated growth**
- **Purchase of a new site was studied and results presented to the parish at that time**

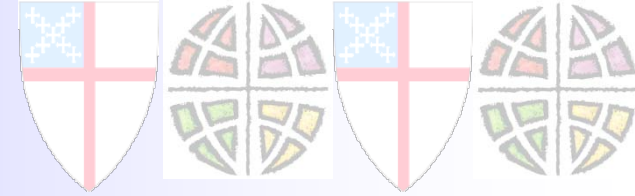

Review of Work of 2006

- **Major change: Adjacent land was purchased through a generous anonymous family donation**
- **Our enlarged site is now capable of handling an expansion**
- **Studied possible concept for expanded campus that**
 - > met the needs for sanctuary and parish hall**
 - > sketch includes the detail of what is now being called 2009 phase I.**
- **Specific future needs for office and class/meeting rooms was not studied.**
- **This concept increased campus size to about 11,000 sq. ft.**

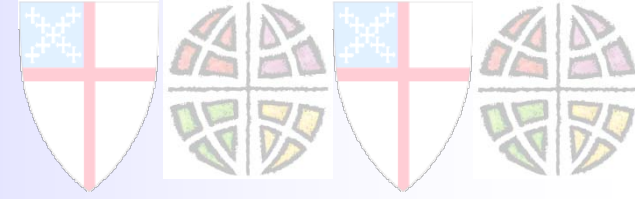

Where are we now?

- **Critical need for additional rooms (concept phase I)**
 - > Expands Polycarp Hall about 14 ft. to South and provides 3 multi-purpose rooms.
 - > Provides temporary storage at East end of Polycarp
 - > Enlarges pantry off kitchen
- **Additional concept studied**
 - > Retain entrance facing South
 - > Rotate sanctuary by 90 degrees, altar at West
 - > Meets requirement for seating
 - > May impact A-frame for engineering reasons
 - > Becker Hall changes
 - > New Polycarp to rear of existing structure meeting seating requirements.
- **Concept increases campus size to over 10,500 sq. ft.**
- **Sensitive area is the impact on the A-frame design**

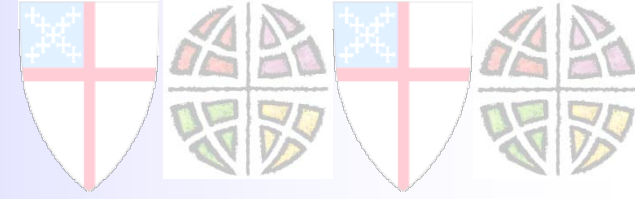

Next Stage(s)

- **Establish an estimate of cost for Phase I concept**
- **Refine the options to better quantify capacity for additional class/meeting rooms**
- **Examine the engineering challenges in detail**
- **Obtain architectural 3-D sketches**
- **Seek parish consensus**
- **Seek Diocese concurrence to concepts**
- **Obtain county approval when appropriate**
- **Establish plan to raise the necessary funds**
- **Remember the enhancement is a long term project**

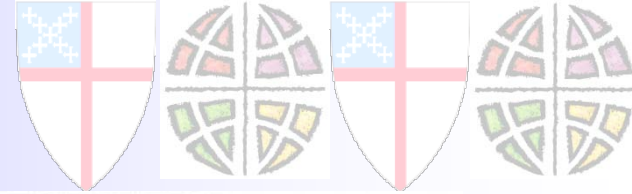

8/14/2009

CHURCH OF OUR SAVIOUR.
CURRENT FLOOR PLAN.

~ 4,500 sq ft
total area.

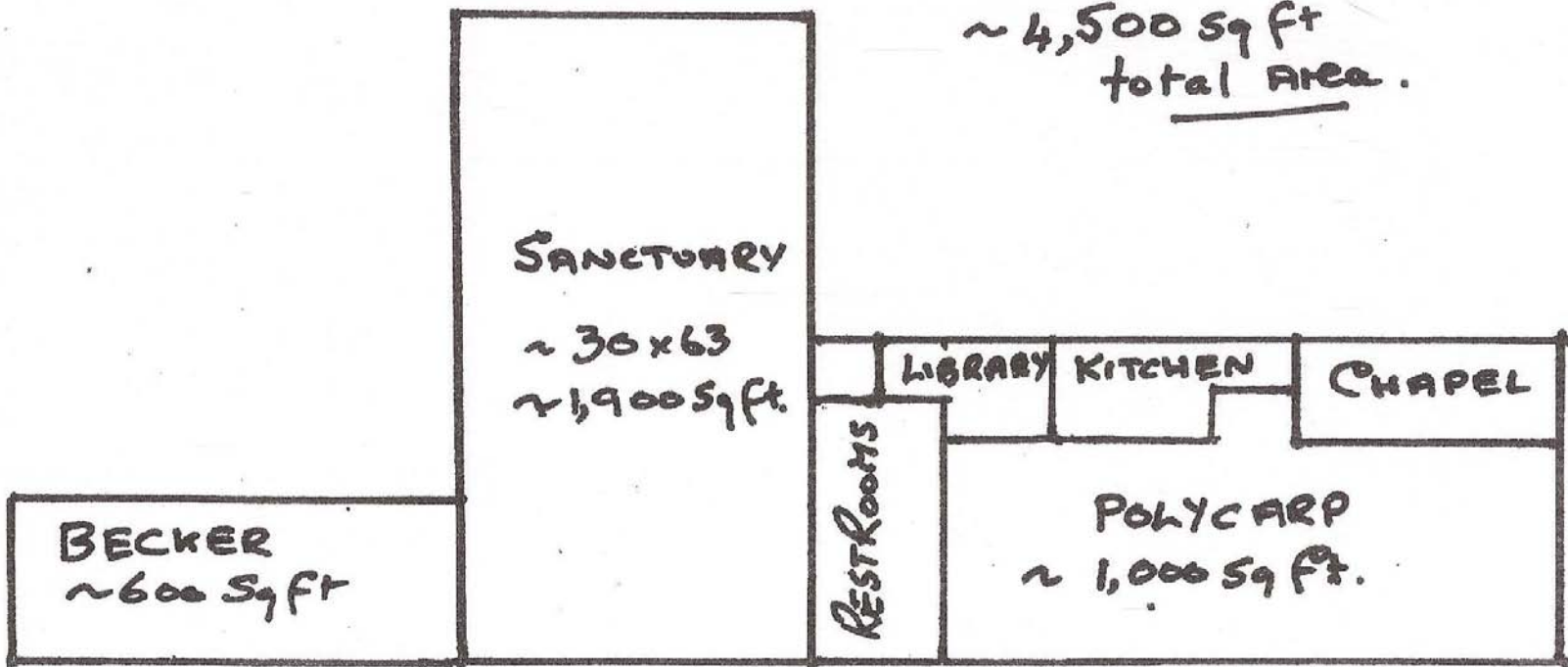

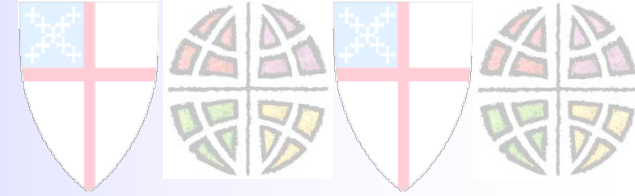

CHURCH OF OUR SAVIOUR
"MODIFIED 2006 CONCEPT" 8/4/2009.
~ 11,000 Sq Ft.

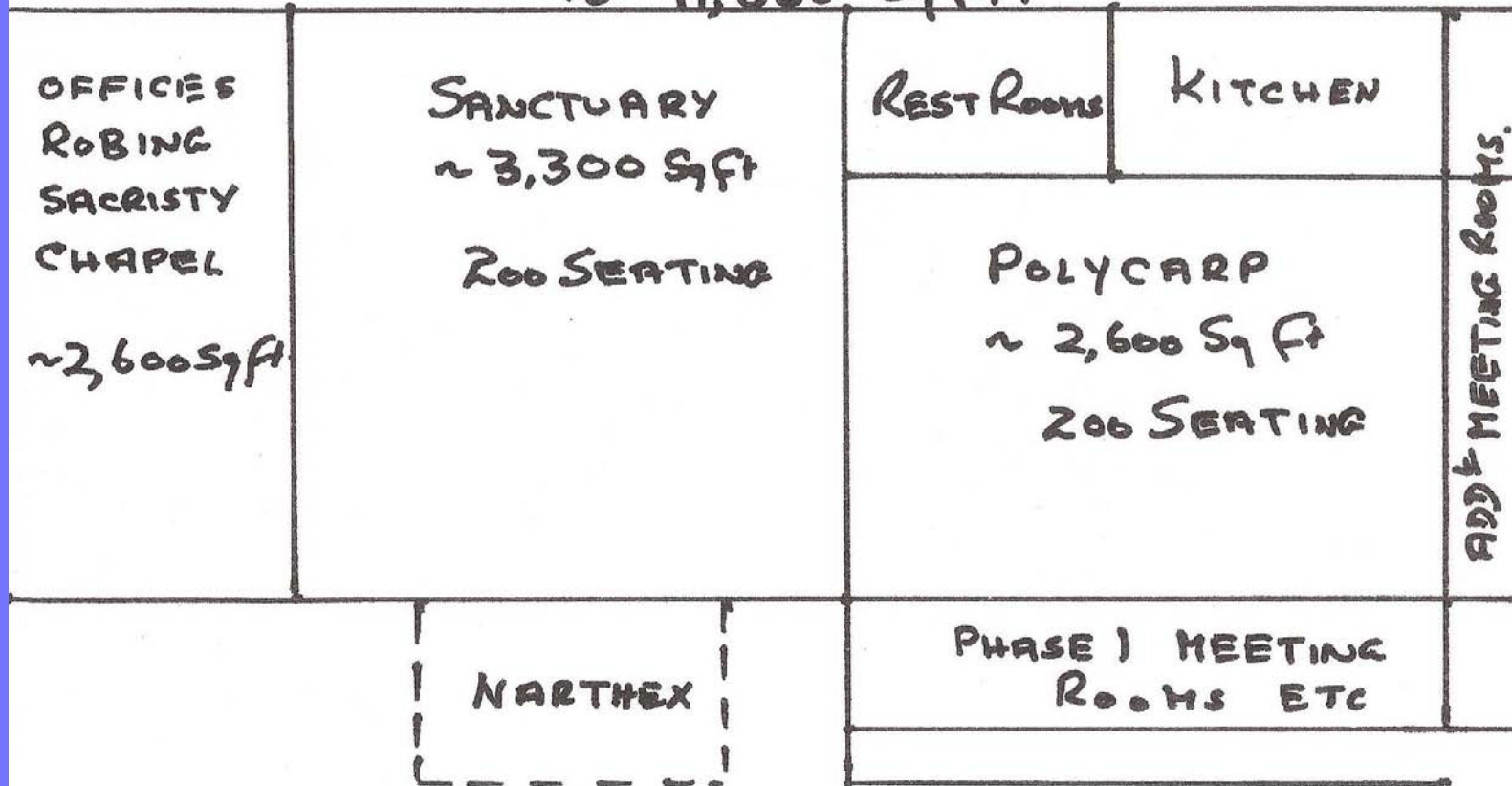

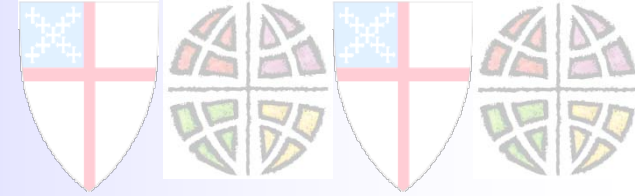

CHURCH OF OUR SAVIOUR
CONCEPT #2, "2009"
~ 10,500 Sq ft.

8/4/2009

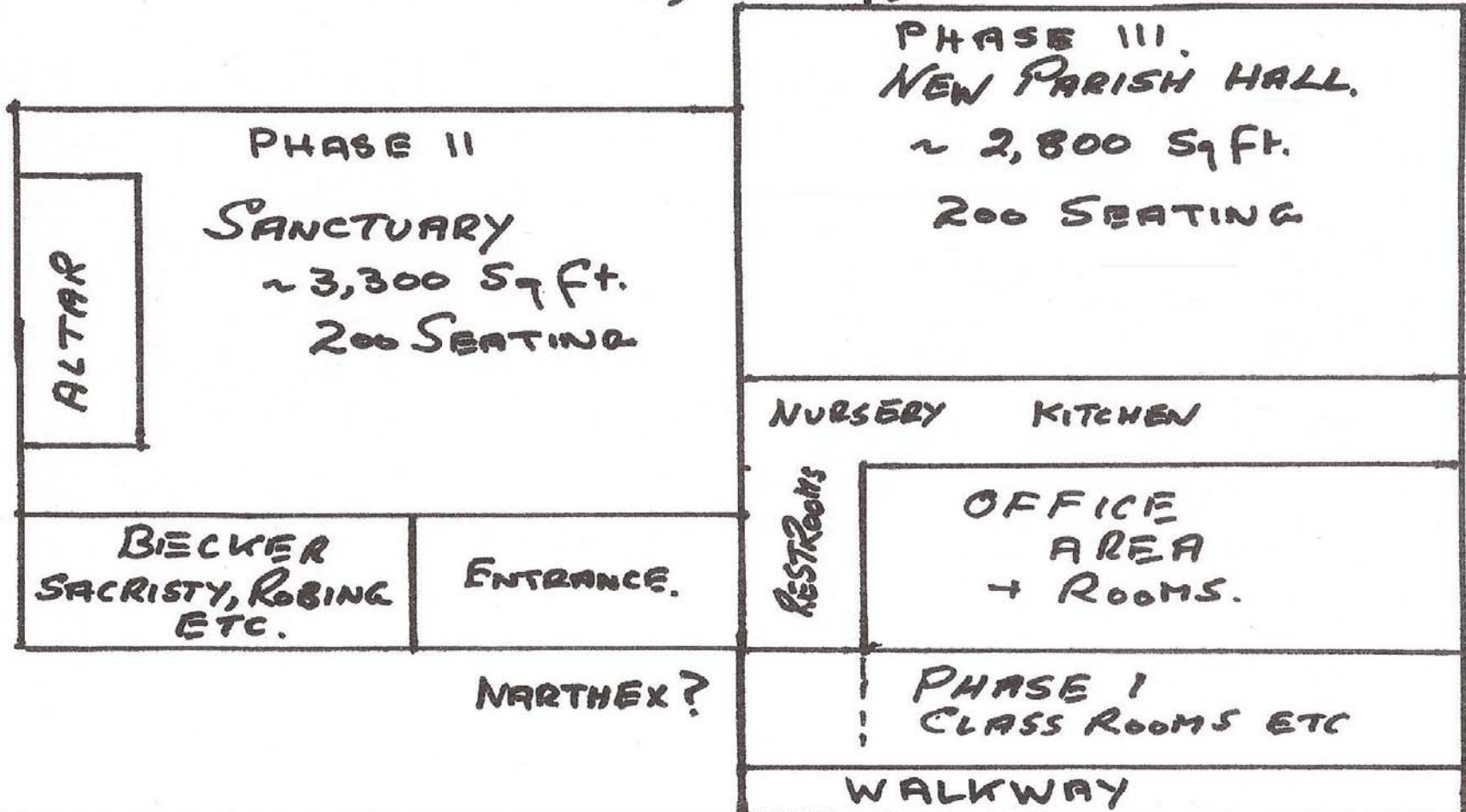

The Church of Our Saviour

Practicing God's Graciousness

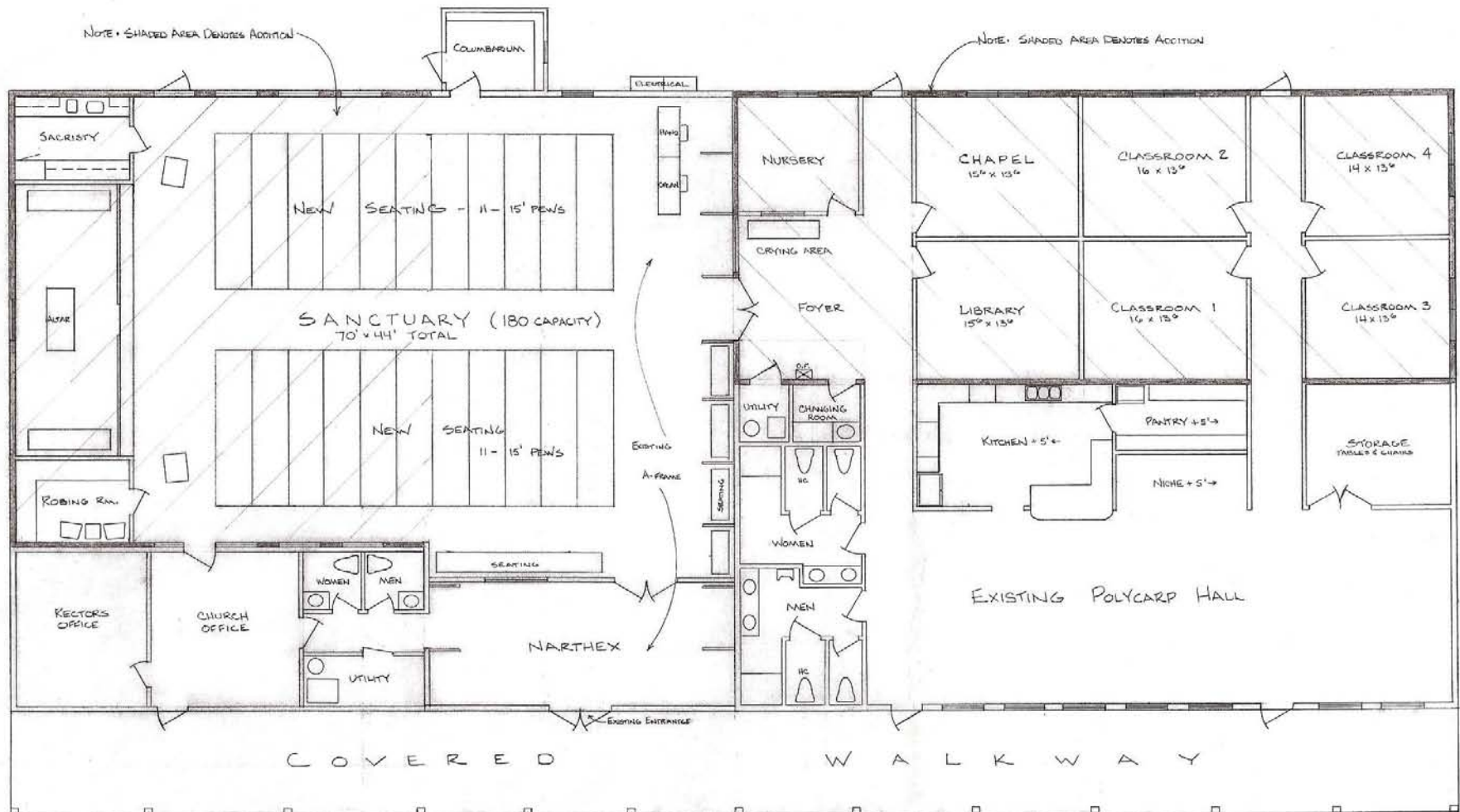
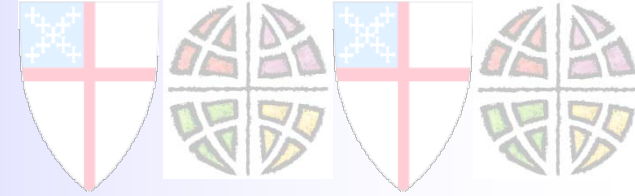

SANCTUARY ADDITION

EXISTING = 1800 SF (80 CAPACITY)
 ADDITION = 1760 SF 40' x 44'
 PROPOSED TOTAL = 3170 SF (180 CAPACITY)
 PROPOSED NARTHEX = 390 SF (30' x 13')
 * NARTHEX LOCATED IN THE FRONT
 13' OF EXISTING SANCTUARY (A-FRAME)

POLYCARP HALL ADDITION

EXISTING SIZE = 2240 SF
 ADDITION SIZE = 1960 SF
 PROPOSED TOTAL = 4200 SF
 TOTAL GAIN = 4 CLASSROOMS,
 1-LIBRARY, 1-CHAPEL, 1-NURSERY,
 1-KITCHEN, 1-FOYER, 1-DEAN

CHURCH OF OUR SAVIOUR
 5147 SHON LON LAKE RD.
 LAKESIDE, AZ. 85729

SCALE AT FULL SIZE (24' x 30')
 1" = 10' SCALE

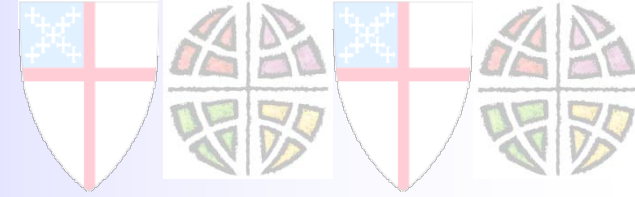

Columbarium Committee

The Church of Our Saviour columbarium has been available since 1987, offering a reasonably priced alternative to burial.

This is an important ministry that honors all our loved ones; a place to come, pray and remember our family and friends; and a lasting memorial for the benefit of the whole Body of Christ.

The committee members are Nikki Nansen, Lois Nansen, Vicki Howell, and Pastor Susan⁺. There will be one vacancy on the committee in January as Nikki steps down.

We are very grateful to Deborah Velasquez for facilitating a generous gift to the columbarium from her mother, Charlene Frey's estate.

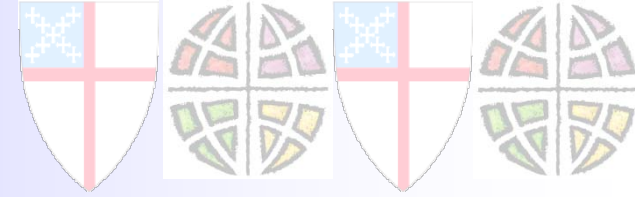

- **Two parishioners have been injured this year.**
- **We have sold 5 niches during this past 7 months.**
- **Currently we have sold 50 of the 64 niches available for sale at \$400 each.**
- **As more niches are sold, more will be installed up to the maximum of 168 niches.**



Welcoming Team Report

- **Sunday Hospitality (Electra Brooks, Chair)**
- **Church Welcome Packets for Newcomers**
- **Quarterly Newcomer Events (Sherry Herring, Chair)**
- **Fellowship Dinners**
- **Memorial service receptions**
- **Journey of Hope dinner (The Lee's and The Nansen's)**
- **Best COS Cookbook Ever (Sandra Rasmussen, Chair, with Vicki Howell, Mary Rose Paterson, and data entry by Beth Spencer and Betty Dohrmann)**
- **Annual Meeting Spaghetti Dinner**
- **Welcome Back Picnic**
- **Semiannual Meeting Potluck**
- **Thomas Bray End of Summer Picnic**

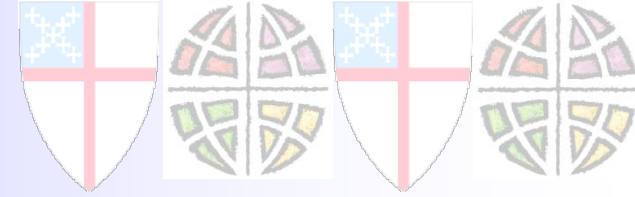

Our 2009-2010 Goals

- **Sell tons of cookbooks! The money collected goes to outreach.**
- **Get as many as are interested involved in Welcome Ministries.**
- **In cooperation with the other ministry teams consider a holiday event between Thanksgiving and Christmas.**
- **To be creative and proactive in welcoming all to The Church of Our Saviour and in Practicing God's Graciousness.**

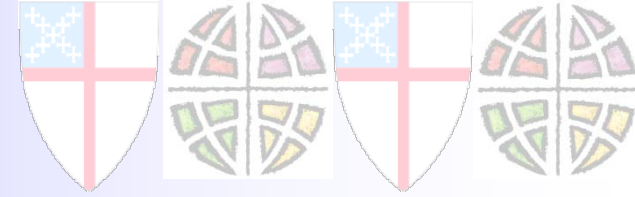

Outreach Team Report

- **Our parish is committed to outreach ministries including support of:**
 - > **the Love Kitchen, Bread of Life Mission, Support our Troops, Hope House, Safe House, Journey of Hope, St. Andrew's Clinic, Angel Tree, Alcoholics Anonymous, ELCA World Hunger, Episcopal Relief and Development, the United Thank Offering, Shepherd's Kitchen, FaithWorks, friends of WEH, etc.**
- **The Outreach Team spent several months discerning God's vision for outreach ministries at COS, and our core values.**

Spirituality

- Outreach must meet needs, including spiritual, emotional & physical.
- God's Will > beyond self & COS.
- God's Work > community participation.
- Showing God's love & the face of Christ – amazing grace – that leads to health.
- Love in action: movement, response and growth.
- Evangelism.
- Celebrates community gifts.
- Listening & discerning.

Resources

- Funds raised are funds shared.
- Practice God's graciousness & good stewardship

Geographic

- Ministries both near and far.
- Ministries within and without the COS community.

Community

- Necessary to do outreach both personally and corporately.
- Hospitality – invites others in and is non-judgmental.
- Diversity.
- Builds community through broad support and participation.
- Evangelism.
- Visibility – including the face of Christ to others.
- Actively doing God's work, many involved & working together.
- Building the Body of Christ: relationships and companionships.



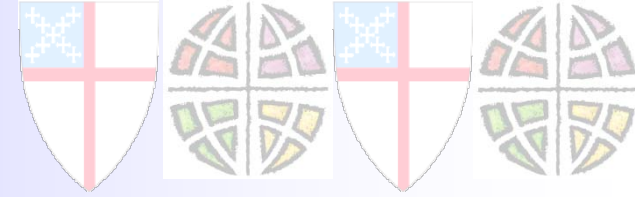

- **Under the outstanding leadership of Gretchen Gottschalk and a fabulous team of volunteers, the 2009 annual rummage sale raised \$4,524 for outreach ministries.**
- **Including the funds raised from the November 2008 Gift Fair and the spring Food Around the World luncheon, the total outreach funds to be disbursed are \$5,264.**
- **All outreach funds are disbursed by application only.**
- **This year's recipients are:**

**The Love Kitchen (\$1000); FaithWorks (\$1000);
St. Andrew's Clinic (\$1000); Shepherd's Kitchen (\$700)
Bread of Life Mission (\$700); WM Meals on Wheels (\$700)**

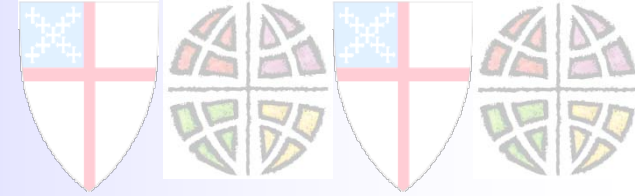

Our 2009-2010 Goals

Outreach is a ministry of every Christian following Christ's example of sacrificial self-giving in love and service to God and our neighbors.

- **As members of the Body of Christ to continue Christ's ministry:**
 - > **to pray for the end of hunger, disease, poverty and injustice;**
 - > **to be an advocate for justice and equality in this community, this country, and the world;**
 - > **to do the work Christ has called us to do by loving and serving our neighbors as ourselves.**
- **To continue to collect and distribute food and clothing for our ministry partners The Love Kitchen and Bread of Life Mission.**
- **To join with our ministry partner FaithWorks on a variety of missions including the Navajo mission trip to Leupp on December 5, 2009.**
- **To remember God's work has no earthly boundaries!**

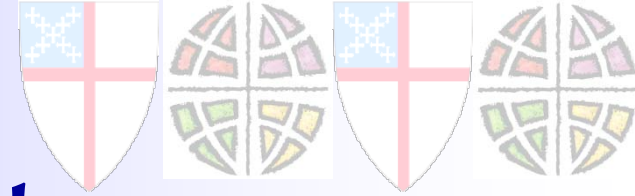

Altar Guild Report

- The work of the Altar Guild is truly a calling.
- Grateful thanks to all members of the Altar Guild for their love, devotion, and service, especially for the additional help during Marcia's absence.
- Deepest appreciation also to all who have made donations to the Altar Guild, blessing us with:
 - > Beautiful flowers each Sunday;
 - > New "Resurrection" linens;
 - > Candles for the altar;
 - > Dry cleaning services; and
 - > Handcrafted wooden planters and a large cross.

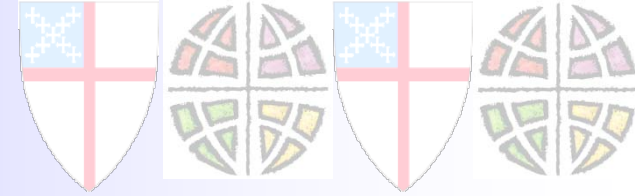

- **The Altar Guild is responsible for the time, care, and devotion in setting the Lord's Table.**
- **Set up must be done for all services ahead of time, and between services on Sundays.**
- **Linens are cared for, metal polished, sacramental vessels cleaned, and the flowers arranged.**
- **The Altar Guild also prepare the Sanctuary for weddings, baptisms, memorials, and special services.**
- **All men and women who feel called to this ministry are invited to speak with Pastor Susan⁺**
- **Help is always needed for set up and clearing, especially on Sundays.**
- **Our linens are cared for by a special gifted lady who has chosen this ministry in service to the Lord.**



The Ministry of the Altar Guild in Pictures

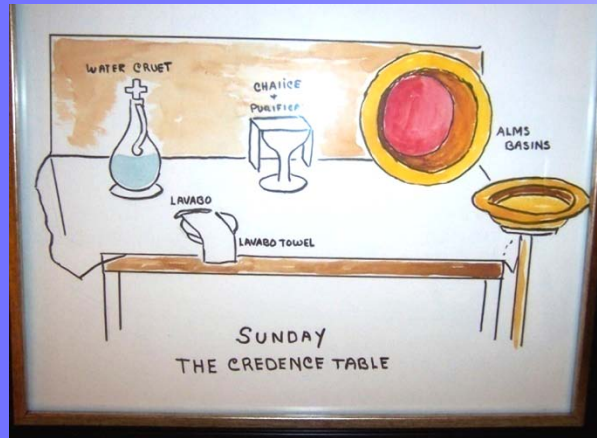

Sunday credence table set up.
Drawing by Marilyn Allen



Easter. White linens marking the celebration of the resurrection with Easter lilies.

Credence Table set for Ash Wednesday service



Altar adorned with Palms & Liturgical red for the start of Holy Week: Palm Sunday

The Church of Our Saviour

Practicing God's Graciousness

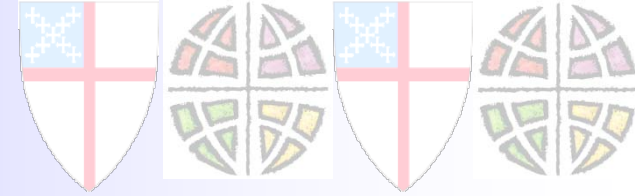

Generous donations to the Altar Guild enhance our worship services.



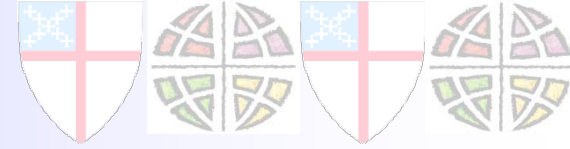

Worship Team Report

- **The Worship team is responsible for training and assisting with the scheduling of our worship leaders, including chalice bearers, acolytes, lay readers, ushers & oblationers.**
- **At the July ministry fair the Worship team presented information highlighting the specific ministries of its members.**
- **The parish secretary prepares the weekly worship leader schedule one month in advance and it is included with the newsletter mailing.**
- **We are very grateful for all who are willing to serve in any of these ministries.**
- **New volunteers are always welcome and training will be given.**

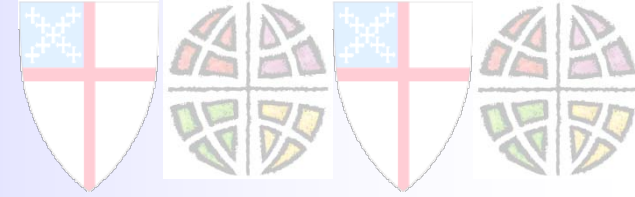

In Pictures!

Ron & Marty LaMar, Ushers



Lily Spencer, Acolyte

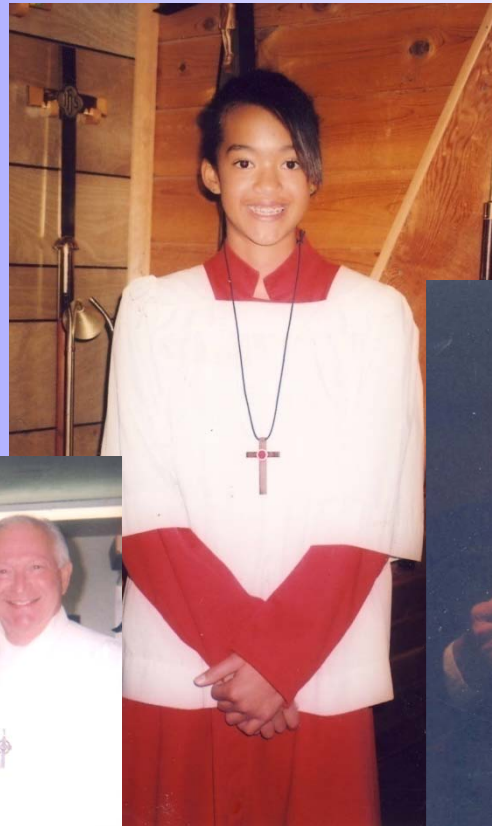

Chuck & Irene Hinman,
Oblationers



Fred Gottschalk, Chalice Bearer, with J.R. and Claire Roubal, Acolytes, and Chuck Hannan, Chalice Bearer

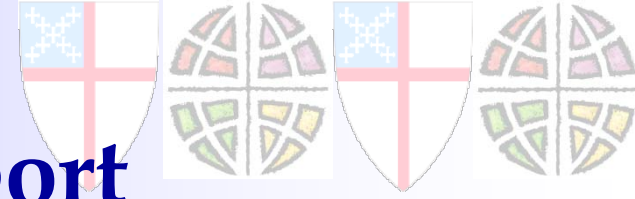

Christian Formation Report

- **Adult Christian formation continues with Bible and book studies facilitated by Chuck Hannan, Lynda Klingler, Jerry Howell, Steve Wilmot & Susan⁺.**
- **Susan⁺ led the Lenten Bible study on the Book of Hosea.**
- **Children's and Youth Christian formation is available every week with Jerry and Nicki Nansen.**
- **Sunday school has followed both the Episcopal Youth Gospel lesson for the week; and currently we are using a new curriculum that is really popular with the children.**
- **Classes are enhanced with craft work, painting, modeling in clay, drawing, and with animals and plants.**
- **Currently 3 of our youth are attending confirmation classes.**
- **We have celebrated two baptisms so far this year.**
- **Vacation Bible School was tremendously successful with over 30 children attending during the week.**

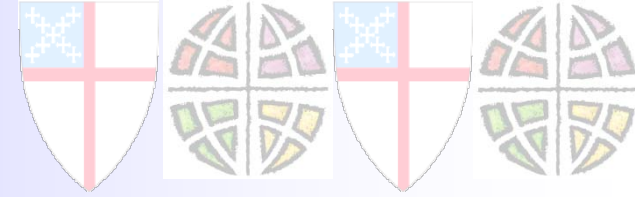

Our Vision for 2009-2010

- We pray that the youth will be interested in forming a youth group, or joining/coordinating with a local church youth group.
- We pray for a nursery for babies and pre-K toddlers & celebrate our nursery care available during the 10am service.
- We will reach out into the broader community by offering Vacation Bible School again next summer.
- We will continue to support Adult Christian formation offerings on Sundays and through Advent and Lenten programs.

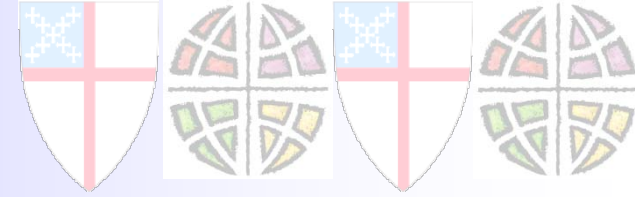

Library – Joey Nelson

- **The church library is alive and doing well.**
- **We now have 706 books and videos available and many periodicals of interest.**
- **Library use has increased, but I'd love to see that trend continue.**
- **Thanks to Carol Justice and to Judy Ginn.**

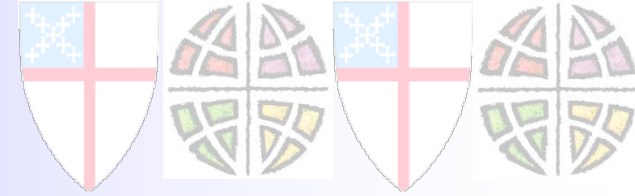

2009-2010 Goals:

- **Increased use of library materials.**
- **Purchase of more videos.**
- **Library computer for on-line holdings and inter-library loans.**

The church library is an outreach ministry! I want to thank the Lord for the spiritual nourishment we receive from the materials in our library.

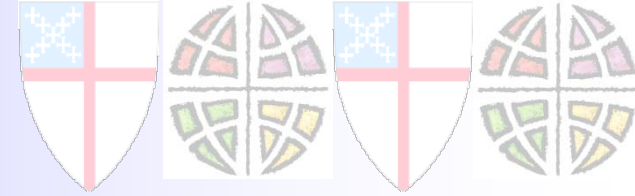

Pastoral Care Team Report

The Pastoral Care Ministry Team includes:

Our Lay Eucharistic Visitors: Ron & Marty Lamar, Chuck Hannan, Steve Wilmot, and Carol Anton;

Our Parish Nursing team: Carol Anton, Katie Cassidy, Barbara Stone; and

Our Card Ministry: Deborah Velasquez

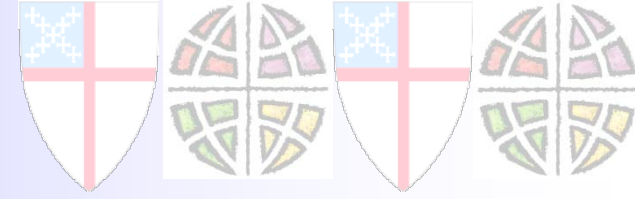

Lay Eucharistic Visitors

- We welcome the leadership of Ron and Marty LaMar and their loving service of pastoral care to all members of this parish.
- All team members have been active in taking Holy Communion to those currently on our list of people receiving regular visits.
- Pastor Susan⁺ holds a training session for all the LEVs to ensure that there is consistency in the Communion service used on home visits.
- If you are interested in joining this ministry please speak with Ron and Marty.

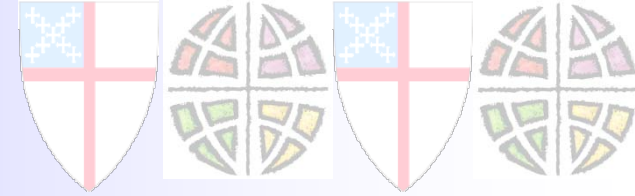

Our LEV Vision for 2009-2010

The Team will make brief announcements from time-to-time, and will insert periodic reminders in the service bulletin for members and visitors to let Pastor Susan⁺ know of people (family members, friends, etc.,) who have difficulty coming to Church, and who would enjoy having a Eucharistic Visitor stop by and bring Holy Communion.

Parish Nursing

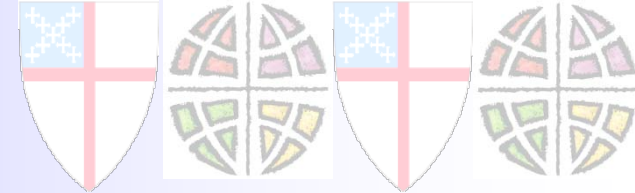

The Parish Nursing ministry is growing and expanding its services to our congregation:

- Currently blood pressure checks are being offered monthly after the 10 am service. Soon there will be the addition of blood pressure checks after the 8 am service every other month.
- A blood donor clinic will be held at COS on Sunday, September 6th from 9 am to 1 pm. Be sure to sign up. Give the gift of life!
- Parish Nurse, Carol Anton, now has a designated area for blood pressure checks in Polycarp Hall.
- A locked file cabinet has been provided to store patient files and medical equipment. However, a dedicated room for the Parish Nurse would greatly enhance services and patient privacy.

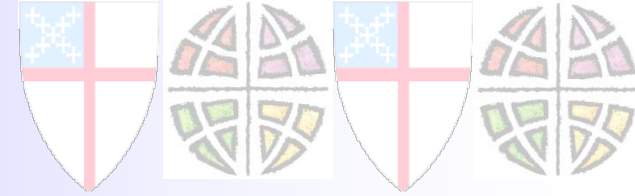

Our Parish Nursing Vision for 2009-2010

- **Based upon survey results, have one or two speakers to conduct educational seminars on topics of interest.**
- **Perhaps hold Medication Clinics, where the trained nurses can review a persons' prescription and non-prescription medications, and advise them of any contra-indications with each other.**
- **Have a dedicated Parish Nursing room available and staffed.**

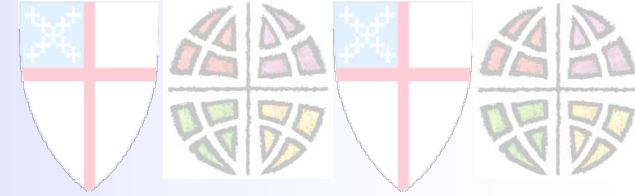

Card Ministry

- Deborah Velasquez has been very active in preparing our get well, sympathy, birthday, and wedding anniversary cards.
- During the last several months these cards have been made available after the Sunday services for members of the congregation to sign. This has been a real gift and blessing to all who receive cards from the entire church family. Thanks for taking the time to sign the cards.

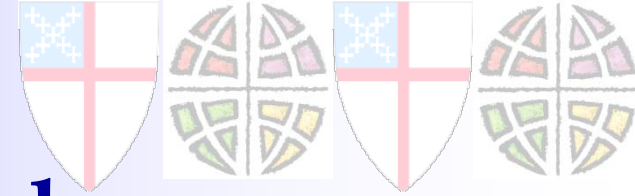

Your Vestry at Work: -- Our Parish Goals

- ✓ **At the vestry retreat in the Spring we began the work of discerning the work that God has called us to in this place. The five key ministry areas discerned are:**
 - 1: Spiritual Growth**
 - 2: Physical Growth (numbers)**
 - 3: Increase number of families with children and youth**
 - 4: Increase Outreach**
 - 5: Facility Expansion**

- ✓ **Each congregation has specific God-given gifts.**

- ✓ **The vestry discerned these to be: faith, hospitality, intercession, knowledge, leadership, mercy, service (helps), skilled crafts, teaching, and practicing & growing in God's graciousness.**

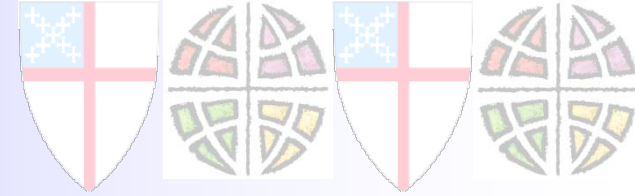

- ✓ Within each of our community Spiritual gifts, the vestry then discerned the opportunities for growth.
- ✓ The goals and ideas were placed in a decision matrix and weighted according to the greatest number of matches for the 5 ministry growth areas.
- ✓ A top 30 list of goals with actions has now been developed, some of which are already complete or underway, and some that are awaiting a champion, according to God's perfect timing.
- ✓ Examples of goals/actions already completed or underway:
 - > Improved curriculum for children and youth Sunday school
 - > Nursery care available during the 10 am service
 - > Pastor to share a "spirituality" series in the parish newsletter
 - > Increase the number of new members
 - > Increased visibility in the community
 - > Increased advertising and marketing efforts
 - > More newsletter articles about our faith traditions & beliefs

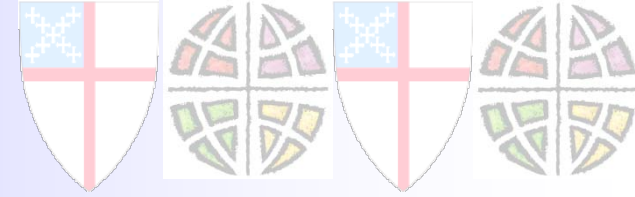

**Together, we can do more and be more as we
serve the Lord,**

Practice God's Graciousness,

grow in our ministries,

and in our spiritual lives.

How?

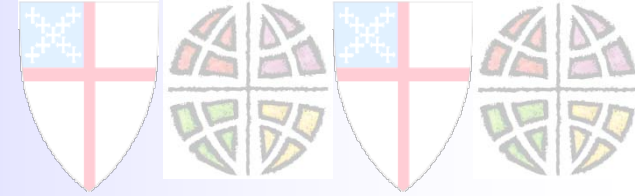

First and foremost with God's help.

And By ...

- Remembering we are empowered by the Holy Spirit to continue Christ's work in the world.
- Praying: to honor the first commandment, and continue to discern God's will for our lives, and the life of this community of faith.
- Gathering together in worship and for Bible study.
- Sharing our Spiritual gifts with thanksgiving.
- Sharing our financial resources with a grateful heart .

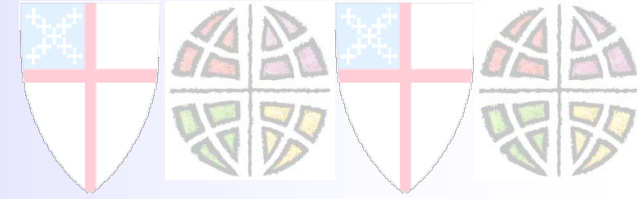

A final thought to ponder...

**The world asks -
How much do you give?**

**Jesus Christ asks -
Why do you give?**

(John Raleigh Mott)

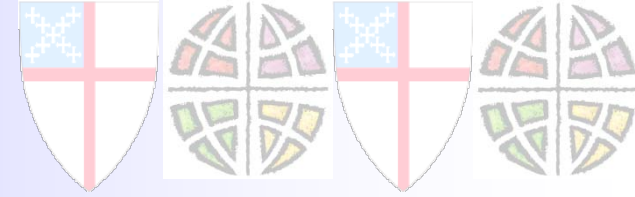

**With grateful thanks to God
for who you are
and all you do.**

*** Please pick up your envelope from the back of the Narthex ****

**Please join us in Polycarp Hall
for a potluck lunch.**

**Alleluia! Alleluia! Go in peace to love
and serve the Lord!**

Thanks be to God! Alleluia! Alleluia!